

FLOS

03.2303.14A Black

Micro Spot NEW

Designed by FLOS Architectural, 2020



Accent lighting LED module to be installed in The Running Magnet System. Built-in DC/DC electronic voltage converter.

Are you a professional and your project needs consulting and support?

[BOOK AN APPOINTMENT](#)

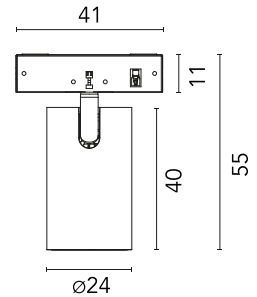

Main specifications

Mounting	Track
Environments	Indoor dry location
Light Source Type	LED
LED type	Power LED
Lamp category	LED
Number of heads	1
Power (W)	3
System power (W)	3
Source flux (lm)	335
System flux (lm)	243
Efficacy (lm/W)	81

Physical

Colour	Black
Orientation	Adjustable
Rotation (°)	267
Longitudinal tilting (°)	90
Spot diameter (mm)	24
Length (mm)	41
Net weight (kg)	0.03
IP internal	20

Download

Mounting instructions [PDF](#)

Photometric Files

LDT / IES [ZIP](#)

Technical Drawings

2D [ZIP](#)

2D [ZIP](#)

3D [ZIP](#)

3D [ZIP](#)

[Bim](#) [ZIP](#)



Schematic light drawing

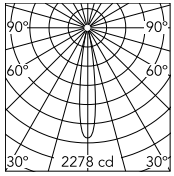

Beam Angle: 16°

h(m)	E(lx)	D(m)
1	2278	0.27
2	570	0.54
3	253	0.82
4	142	1.09
5	91	1.36

Luminous flux Luminaire
243 lm

Ecodesign and Energy Labelling

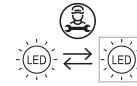

Replaceable (LED only)
light source by a
professional

Photometric

Lighting type	Direct
Light distribution	Symmetric
CCT (K)	5000
CRI>	90
McAdam steps (SDCM)	2
Beam angle C0-180 (°)	16
Beam angle C90-270 (°)	16
UGR _L	12

Electrical

Insulation class	III
Main voltage (Vac)	
Forward voltage (V)	24
LED voltage Vf (Vdc)	24
Driver	Remote excluded
Dimmable	Yes
Dimming type	Non Dimmable, Dimmable
Dimming interface	Remote Dimmable (Dimmer Not Included)

Notes

Honeycomb accessory available. Must be ordered separately.

Accessories & Power Supply



OPTIONAL
Accessory

Optical

08.0190.14

Honeycomb for Micro Spot