

# FLOS

03.8933.40A White/Black

## Light Shadow Adjustable No Trim 8 Spots Optic Spot

Designed by FLOS Architectural



Recessed integrated luminaire with 8 LED lighting spots. Remote power supply included (220-240V).

Are you a professional and your project needs consulting and support?

[BOOK AN APPOINTMENT](#)

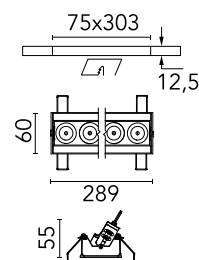

### Main specifications

|                  |                     |
|------------------|---------------------|
| Mounting         | Ceiling recessed    |
| Environments     | Indoor dry location |
| LED type         | Power LED           |
| Lamp category    | LED                 |
| Iicos            | No                  |
| Number of heads  | 1                   |
| Power (W)        | 21.6                |
| Source flux (lm) | 2160                |
| System flux (lm) | 1747                |

### Physical

|                          |             |
|--------------------------|-------------|
| Colour                   | White/Black |
| Trim                     | No          |
| Orientation              | Adjustable  |
| Longitudinal tilting (°) | 30          |
| Recessed depth (mm)      | 75          |
| Length (mm)              | 289         |
| Net weight (kg)          | 0.50        |
| IP internal              | 20          |
| IP external              | 20          |

### Download

[Mounting instructions](#) ZIP

### Photometric Files

[LDT / IES](#) ZIP

### Technical Drawings

[2D](#) ZIP

[3D](#) ZIP

[Bim](#) ZIP



## Schematic light drawing

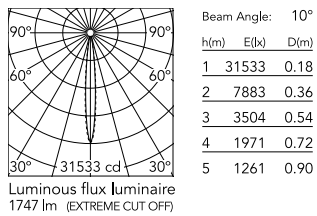

### Photometric

|                        |           |
|------------------------|-----------|
| Lighting type          | Direct    |
| Light distribution     | Symmetric |
| CCT (K)                | 2700      |
| CRI>                   | 90        |
| Beam angle C0-180 (°)  | 10        |
| Beam angle C90-270 (°) | 10        |

### Electrical

|                                   |                 |
|-----------------------------------|-----------------|
| Insulation class                  | II              |
| Frequency (Hz)                    | 50/60           |
| Main voltage (Vac)                | 220.00          |
| Alternating current voltage (Vac) | 230             |
| LED voltage Vf (Vdc)              | 24              |
| Driver                            | Remote included |
| Dimmable                          | No              |
| Emergency type                    | No              |

### Notes

It requires a pre-installation frame, to be ordered separately.

## Accessories & Power Supply



REQUIRED  
Frame

Installation

08.0517.00

Pre-installation No Trim Frame 8L  
Fix Adjustable



OPTIONAL  
Accessory

Mounting

08.0059.90

Accessory for mounting of No  
Trim Adjustable continuous line.