

# Qbini LED WARM DIM GE

141041XX\_141042XX\_141141XX\_141142XX\_141241XX\_141242XX\_141341XX\_141342XX\_141441XX\_141442XX\_141541XX\_141542XX

CAN BE USED WITH:  
[www.supermodular.com](http://www.supermodular.com) or check sales contact

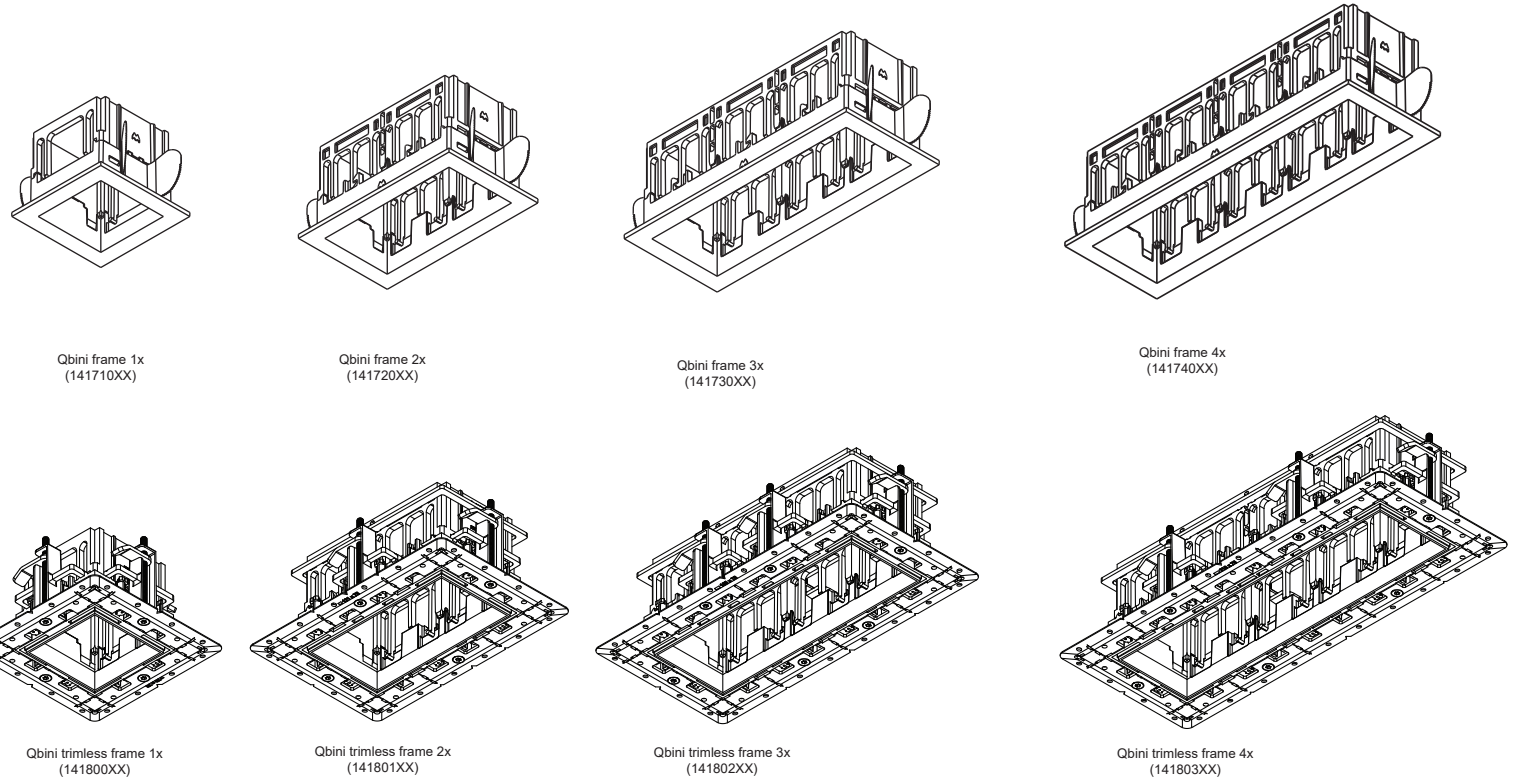
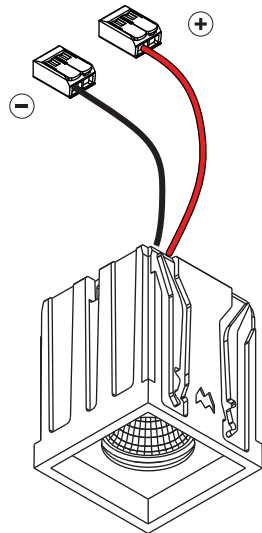

Drive Current (mA)	Forward Voltage		Power (W)
	min (Vf)	max (Vf)	
250	15,5	18,5	4
For serial connection, respect polarity!			
⊕ RED		⊖ BLACK	

## ACCESSORIES

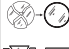

 The light source contained in this luminaire shall only be replaced by the manufacturer or his service agent or a similar qualified person

 Replace protective shield when broken. The luminaire shall only be used complete with its protective shield. Reference number: 1012728

