

FLOS

03.8157.14.1V Black

Spot 120 Dimmable 1-10V

Designed by FLOS Architectural, 2017



Accent lighting LED module.

Are you a professional and your project needs consulting and support?

[BOOK AN APPOINTMENT](#)

Main specifications

| | |
|-------------------|---------------------|
| Mounting | Track |
| Environments | Indoor dry location |
| Light Source Type | LED |
| LED type | LED array |
| Lamp category | LED |
| Iicos | No |
| Bulb finish | Clear |
| Number of heads | 1 |
| Power (W) | 12.5 |
| System power (W) | 12.5 |
| Source flux (lm) | 968 |
| System flux (lm) | 629 |
| Efficacy (lm/W) | 50.32 |

Physical

| | |
|--------------------------|------------|
| Colour | Black |
| Trim | No |
| Orientation | Adjustable |
| Rotation (°) | 360 |
| Longitudinal tilting (°) | 90 |
| Spot diameter (mm) | 46 |
| Length (mm) | 178 |
| Net weight (kg) | 0.29 |
| IP internal | 20 |
| IP external | 20 |

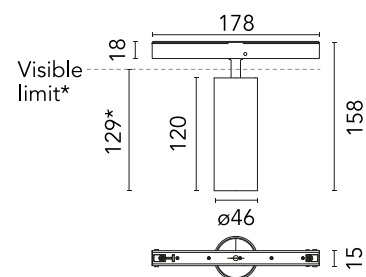

*installed in The Tracking Magnet

Download

Mounting instructions [↓ PDF](#)

Photometric Files

LDT / IES [↓ ZIP](#)

Technical Drawings

2D [↓ ZIP](#)

3D [↓ ZIP](#)

[↓ ZIP](#) Bim



Schematic light drawing

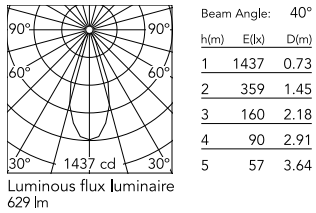

Photometric

| | |
|--------------------------|-----------|
| Lighting type | Direct |
| Light distribution | Symmetric |
| CCT (K) | 3000 |
| CRI> | 90 |
| McAdam steps (SDCM) | 2 |
| LED Life / Failure Ratio | L80B50 |
| Beam angle C0-180 (°) | 40 |
| Beam angle C90-270 (°) | 40 |
| UGR _L | 17 |

Electrical

| | |
|----------------------|---------------------------------------|
| Insulation class | III |
| Forward voltage (V) | 48 |
| LED voltage Vf (Vdc) | 48 |
| LED current (mA) | 350 |
| Driver | Remote excluded |
| Dimmable | Yes |
| Dimming type | Dimmable 1-10V |
| Dimming range (%) | 10-100 |
| Dimming interface | Remote Dimmable (Dimmer Not Included) |
| Emergency type | No |

Ecodesign and Energy Labelling



Replaceable (LED only) light source by a professional



Replaceable control gear by a professional

Notes

Accessories included (honeycomb and screening crosspiece). Only compatible with 1-10V profile version.