

FLOS

03.8042.40ADA White

Spot 90 Dali Version

Designed by FLOS Architectural, 2017



Accent lighting LED module.

Are you a professional and your project needs consulting and support?

[BOOK AN APPOINTMENT](#)

Main specifications

Mounting	Track
Environments	Indoor dry location
Light Source Type	LED
LED type	Power LED
Lamp category	LED
Iicos	No
Bulb finish	Clear
Number of heads	1
Power (W)	8.5
System power (W)	8.5
Source flux (lm)	610
System flux (lm)	428
Efficacy (lm/W)	50.35

Physical

Colour	White
Trim	No
Orientation	Adjustable
Rotation (°)	360
Longitudinal tilting (°)	90
Spot diameter (mm)	35
Length (mm)	178
Net weight (kg)	0.17
IP internal	20
IP external	20

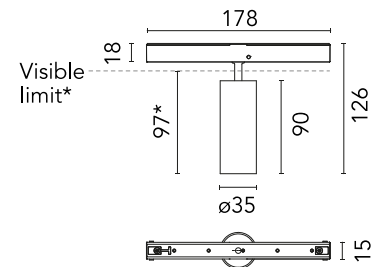

*installed in The Tracking Magnet

Download

Mounting instructions [↓ PDF](#)

Photometric Files

LDT / IES [↓ ZIP](#)

Technical Drawings

2D [↓ ZIP](#)

3D [↓ ZIP](#)

[↓ ZIP](#) Bim



Schematic light drawing

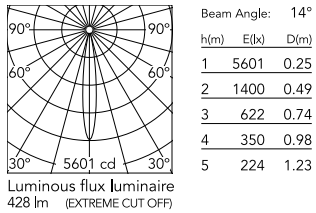

Photometric

Lighting type	Direct
Light distribution	Symmetric
CCT (K)	2700
CRI>	90
McAdam steps (SDCM)	2
LED Life / Failure Ratio	L80B50
Beam angle C0-180 (°)	14
Beam angle C90-270 (°)	14
UGR _L	3

Electrical

Insulation class	III
Forward voltage (V)	48
LED voltage Vf (Vdc)	48
LED current (mA)	600
Driver	Remote excluded
Dimmable	Yes
Dimming type	Dimmable DALI 2
Dimming range (%)	30-100
Dimming interface	Remote Dimmable (Dimmer Not Included)
Emergency type	No

Ecodesign and Energy Labelling

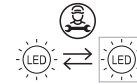

Replaceable (LED only) light source by a professional



Replaceable control gear by a professional

Notes

Accessories included (honeycomb and screening crosspiece). Only compatible with DALI profile version.