

NEW CEILING BALDACHIN ROUND

29-Feb.-2016

CE IP20

White texture
Black texture

90052005
90052006

mounting plate dimension:

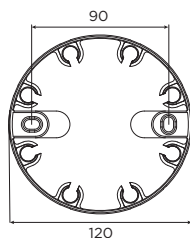

①

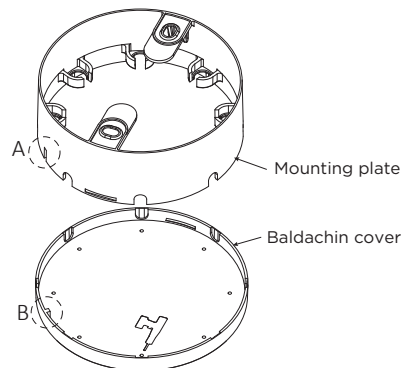

WARNING: the slot A and raised section B should be aligned when installation.

Wiring method 1:

(Check page 2 for overall view details)

②

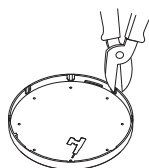

⑤

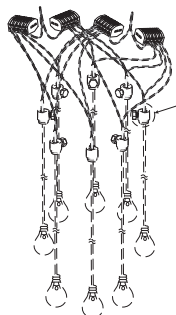

④

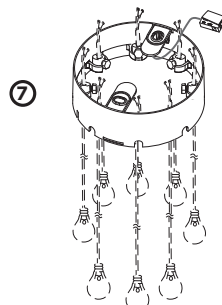

⑦

Wiring method 2:

③

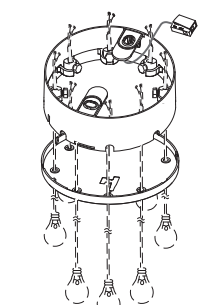
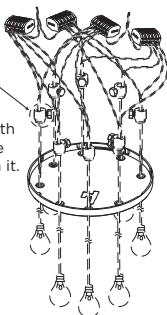
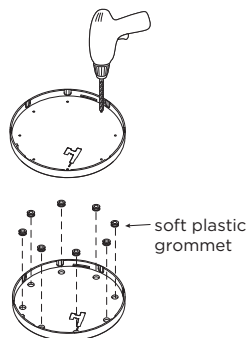

strain relief

adjusting knob

When the cable length is determined, please remember to tighten it.

DIMENSIONS

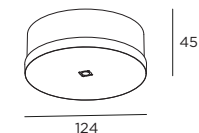

MOUNTING INSTRUCTION

- ① Remove the mounting plate from the baldachin cover. Fix the mounting plate on the ceiling with screws.
* **There are two wiring method:**
Method 1: the lamp cables go through the wall of the Mounting plate;
Method 2: the lamp cables go through the bottom of the Baldachin cover.
- ② Make holes on the Baldachin cover for lamp cables.
- ③ Put the grommets into the holes. (This step applies to the Method 2.)
- ④ Adjust the cables of luminaire to desired length, tighten the strain reliefs
- ⑤ Connect the luminaire cables into the terminals.

⑥ POWER CONNECTION

When the luminaire number is less than 5

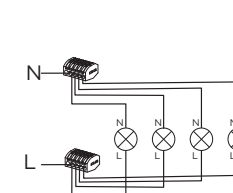

When the luminaire number is greater than 4

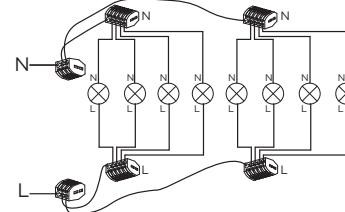

Baldachin cover earthing connector:



- ⑦ Hang the strain reliefs on the holders.



WEVER & DUCRÉ
LIGHTING

www.weverducre.com

INSTALLATION
INSTRUCTIONS

PAGE 1/2

NEW CEILING BALDACHIN ROUND

29-Feb.-2016

Wiring method 1:

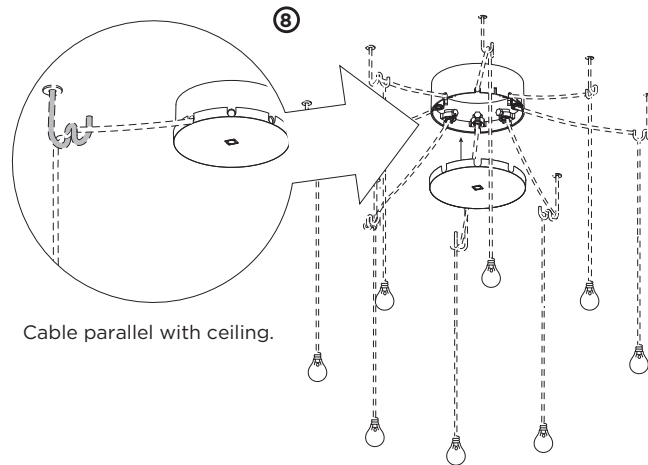

Wiring method 2:

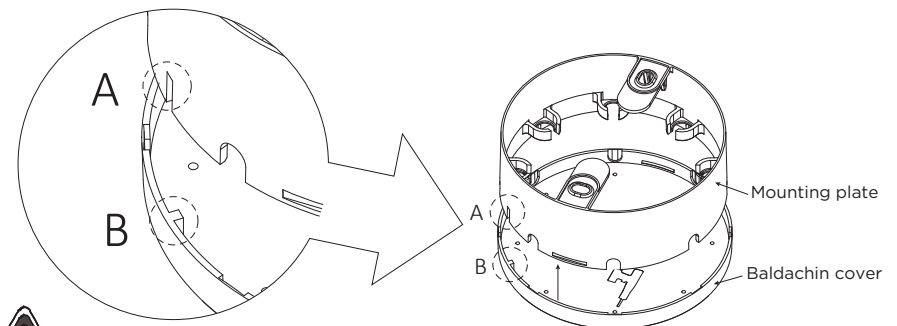
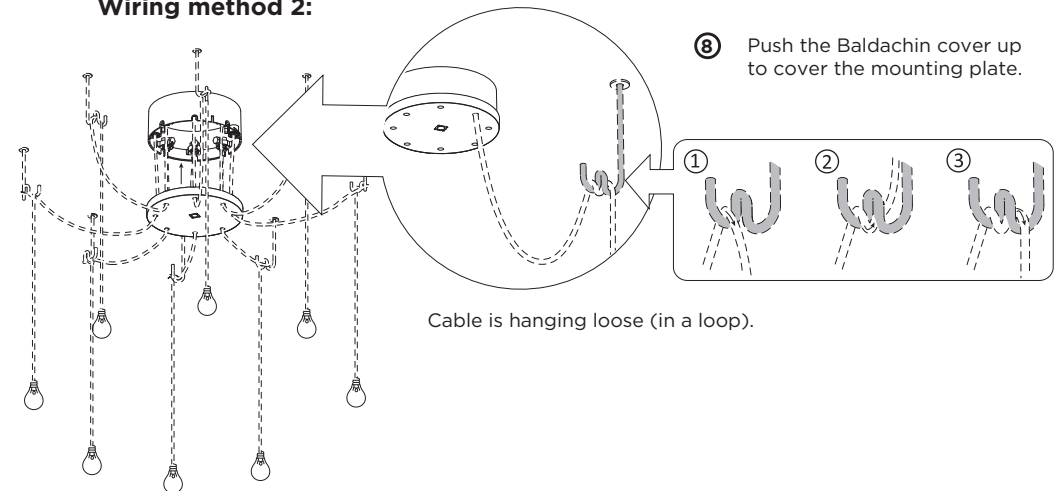

WARNING: When push the baldachin cover up to the mounting plate, please make sure the slot A and raised section B are aligned.