

FLOS

03.8042.40ACB White

Spot 90 Casambi integrated NEW

Designed by FLOS Architectural, 2020



Accent lighting LED module.

Are you a professional and your project needs consulting and support?

[BOOK AN APPOINTMENT](#)

Main specifications

Mounting	Track
Environments	Indoor dry location
Light Source Type	LED
LED type	Power LED
Lamp category	LED
Iicos	No
Bulb finish	Clear
Number of heads	1
Power (W)	8.5
System power (W)	8.5
Source flux (lm)	610
System flux (lm)	428
Efficacy (lm/W)	50.35

Physical

Colour	White
Trim	No
Orientation	Adjustable
Rotation (°)	360
Longitudinal tilting (°)	90
Spot diameter (mm)	35
Length (mm)	178
Net weight (kg)	0.17
IP internal	20
IP external	20

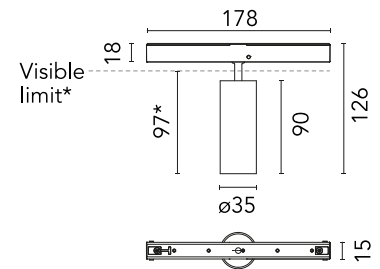

*installed in The Tracking Magnet

Download

Mounting instructions [↓ PDF](#)

Photometric Files

LDT / IES [↓ ZIP](#)

Technical Drawings

2D [↓ ZIP](#)

3D [↓ ZIP](#)

[↓ ZIP](#) Bim

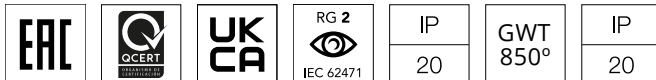

Schematic light drawing

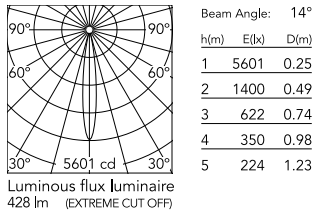

Ecodesign and Energy Labelling

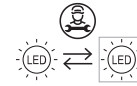

Replaceable (LED only) light source by a professional

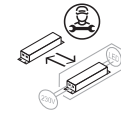

Replaceable control gear by a professional

Photometric

Lighting type	Direct
Light distribution	Symmetric
CCT (K)	2700
CRI>	90
McAdam steps (SDCM)	2
LED Life / Failure Ratio	L80B50
Beam angle C0-180 (°)	14
Beam angle C90-270 (°)	14
UGR _L	3

Electrical

Insulation class	III
Main voltage (Vac)	48
Forward voltage (V)	48
LED voltage Vf (Vdc)	48
LED current (mA)	600
Driver	Remote excluded
Dimmable	Yes
Dimming type	Dimmable Casambi
Dimming range (%)	30-100
Dimming interface	Remote Dimmable (Dimmer Not Included)
Emergency type	No

Notes

Accessories not suitable for chrome finishes. The control system with the Casambi version of light fixtures is directly and individually regulated wirelessly using the application FLOS Control@ by Casambi.