

FLOS

03.2227.40A White

Micro Spot NEW

Designed by FLOS Architectural, 2020



LED - Power LED - 3W - 217lm - 4000K - CRI> 90 - Beam° 31

Accent lighting LED module to be installed in The Running Magnet System. Built-in DC/DC electronic voltage converter.

Are you a professional and your project needs consulting and support?

[BOOK AN APPOINTMENT](#)

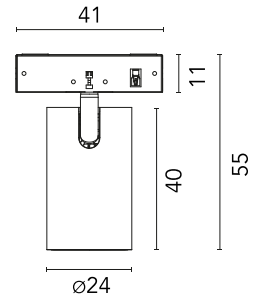

Main specifications

Mounting	Track
Environments	Indoor dry location
Light Source Type	LED
LED type	Power LED
Lamp category	LED
Number of heads	1
Power (W)	3
System power (W)	3
Source flux (lm)	315
System flux (lm)	217
Efficacy (lm/W)	72.33

Physical

Colour	White
Orientation	Adjustable
Rotation (°)	267
Longitudinal tilting (°)	90
Spot diameter (mm)	24
Length (mm)	41
Net weight (kg)	0.03
IP internal	20

Download

[Mounting instructions](#) PDF

Photometric Files

[LDT / IES](#) ZIP

Technical Drawings

[2D](#) ZIP

[2D](#) ZIP

[3D](#) ZIP

[3D](#) ZIP

[Bim](#) ZIP



Schematic light drawing

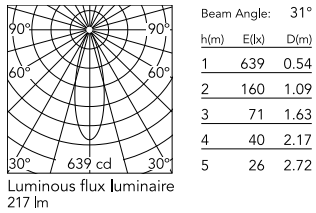

Ecodesign and Energy Labelling

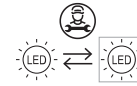

Replaceable (LED only)
light source by a
professional

Photometric

Lighting type	Direct
Light distribution	Symmetric
CCT (K)	4000
CRI>	90
McAdam steps (SDCM)	2
Beam angle C0-180 (°)	31
Beam angle C90-270 (°)	30
UGR _L	17

Electrical

Insulation class	III
Main voltage (Vac)	
Forward voltage (V)	24
LED voltage Vf (Vdc)	24
Driver	Remote excluded
Dimmable	Yes
Dimming type	Non Dimmable, Dimmable
Dimming interface	Remote Dimmable (Dimmer Not Included)

Accessories & Power Supply



OPTIONAL
Accessory

Optical

08.0190.14

Honeycomb for Micro Spot