

FLOS

03.8156.40.1V White

Spot 120 Dimmable 1-10V

Designed by FLOS Architectural, 2017



LED - LED array - 12.5W - 599lm - 2700K - CRI> 90 - Beam° 40

Accent lighting LED module.

Are you a professional and your project needs consulting and support?

[BOOK AN APPOINTMENT](#)

Main specifications

Mounting	Track
Environments	Indoor dry location
Light Source Type	LED
LED type	LED array
Lamp category	LED
Iicos	No
Bulb finish	Clear
Number of heads	1
Power (W)	12.5
System power (W)	12.5
Source flux (lm)	921
System flux (lm)	599
Efficacy (lm/W)	47.92

Physical

Colour	White
Trim	No
Orientation	Adjustable
Rotation (°)	360
Longitudinal tilting (°)	90
Spot diameter (mm)	46
Length (mm)	178
Net weight (kg)	0.29
IP internal	20
IP external	20

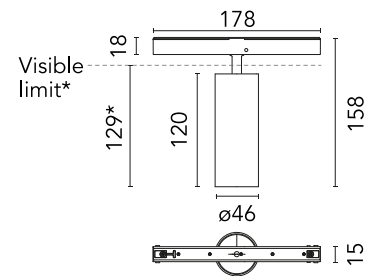

*installed in The Tracking Magnet

Download

Mounting instructions [↓ PDF](#)

Photometric Files

LDT / IES [↓ ZIP](#)

Technical Drawings

2D [↓ ZIP](#)

3D [↓ ZIP](#)

[↓ ZIP](#) Bim



Schematic light drawing

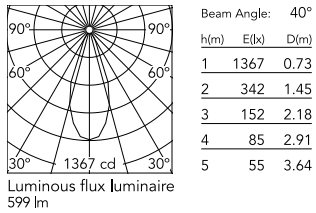

Photometric

Lighting type	Direct
Light distribution	Symmetric
CCT (K)	2700
CRI>	90
McAdam steps (SDCM)	2
LED Life / Failure Ratio	L80B50
Beam angle C0-180 (°)	40
Beam angle C90-270 (°)	40
UGR _L	17

Electrical

Insulation class	III
Forward voltage (V)	48
LED voltage Vf (Vdc)	48
LED current (mA)	350
Driver	Remote excluded
Dimmable	Yes
Dimming type	Dimmable 1-10V
Dimming range (%)	10-100
Dimming interface	Remote Dimmable (Dimmer Not Included)
Emergency type	No

Ecodesign and Energy Labelling



Replaceable (LED only) light source by a professional



Replaceable control gear by a professional

Notes

Accessories included (honeycomb and screening crosspiece).
Only compatible with 1-10V profile version.