

# FLOS

F3680046 Bronze

## La Plus Belle

Designed by Philippe Starck, 2019



60W - 2700K

Plus Belle is a mirror with incorporated light sources. The aluminium frame is available in various finishes (brushed gold, brushed copper, polished bronze and brill, and houses high chromatic rendering led light sources (CRI 95) and an optical opal silicone diffuser. The mirror is made of 6 mm extra-clear glass, with a layer of safety and aesthetic film to the rear, and it is fixed to the frame by means of a polycarbonate glazing bead. The Plus Belle mirror is hung from the wall by means of an aesthetic effect hook with a dual magnet fixing device to keep it in position. It is powered by means of a wall-mounted power supply unit or IEC cable and connector socket. The optic sensor command fitted to the mirror or remote 0-10/1-10 V - PUSH - DALI control can be used as a dimmer to adjust the light intensity by 10% to 100% in either direction.

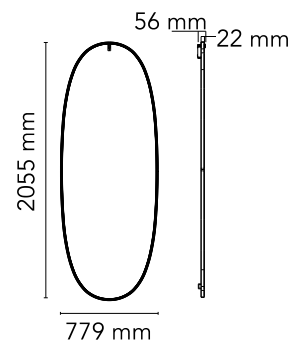

Are you a professional and your project needs consulting and support?

[BOOK AN APPOINTMENT](#)

### Main specifications

EAN	8059607005033
Mounting	Wall
Environments	Indoor dry location
Light Source Type	LED
LED type	LED Module
Power (W)	60

### Physical

Colour	Bronze
Length (mm)	56
Net weight (kg)	24.5
Package height (mm)	1015
Package width (mm)	130
Package length (mm)	2315
Package volume (m3)	0.31
IP internal	20

### Download

[Mounting instructions](#)

[PDF](#)

### Ecodesign and Energy Labelling

This product contains a light source of energy efficiency class E

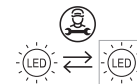

Replaceable (LED only) light source by a professional

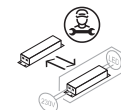

Replaceable control gear by a professional



## Photometric

Lighting type	Indirect, Direct
Light distribution	Asymmetric
CCT (K)	2700

## Electrical

Insulation class	II
Frequency (Hz)	50/60
Main voltage (Vac)	120-277
Driver	Integrated
Dimmable	Yes
Dimming type	Dimmable
Dimming interface	Dimmer Integrated
Plug type	Type C
Batteries inside	No

## Spare Parts

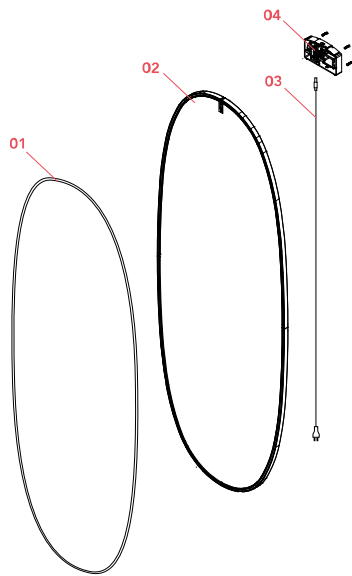

- |     |                              |           |
|-----|------------------------------|-----------|
| 01. | Opal silicone diffuser ring  | RF3680100 |
| 02. | Anodized bronze mirror hook  | RF3680246 |
| 03. | Electrical mounting assembly | RF3680300 |
| 04. | Anodized bronze power unit   | RF3680446 |



RF3680100

Opal silicone diffuser ring



RF3680246

Anodized bronze mirror hook



RF3680300

Electrical mounting assembly



RF3680446

Anodized bronze power unit