

FLOS

03.6303.14B Black

Spot Module On Board Dimmer

Designed by FLOS Architectural, 2016



Accent lighting LED module to be installed in The Running Magnet System. Built-in DC/DC electronic voltage converter.

Are you a professional and your project needs consulting and support?

BOOK AN APPOINTMENT

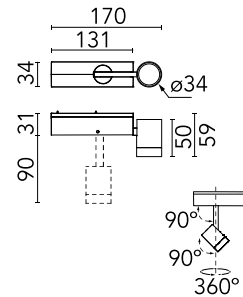

Main specifications

Mounting	Track
Environments	Indoor dry location
Light Source Type	LED
LED type	Power LED
Lamp category	LED
Iicos	No
Bulb finish	Clear
Number of heads	1
Power (W)	8
System power (W)	8.4
System flux (lm)	403
Efficacy (lm/W)	47.98

Physical

Colour	Black
Trim	No
Orientation	Adjustable
Rotation (°)	360
Longitudinal tilting (°)	90
Spot diameter (mm)	34
Length (mm)	34
Net weight (kg)	0.19
IP internal	20
IP external	20

Download

Mounting instructions [↓ PDF](#)

Photometric Files

LDT / IES [↓ ZIP](#)

Technical Drawings

2D [↓ ZIP](#)

3D [↓ ZIP](#)

[↓ ZIP](#)

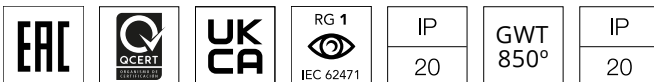

Schematic light drawing

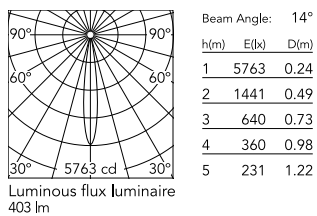

Photometric

Lighting type	Direct
Light distribution	Symmetric
CCT (K)	2700
CRI>	90
McAdam steps (SDCM)	3
LED Life / Failure Ratio	L80B50
Beam angle C0-180 (°)	14
Beam angle C90-270 (°)	14
UGR _L	14

Electrical

Insulation class	III
Main voltage (Vac)	24
Forward voltage (V)	24
Driver	Remote excluded
Dimmable	Yes
Dimming type	Dimmer on board
Dimming range (%)	20-100

Notes

Maximum 21 spots for a single driver. For wireless lighting control, choose integrated Casambi versions.

Accessories & Power Supply



OPTIONAL
Accessory

Optical

08.8427.14

Screening external ring for
Running Magnet spot module



OPTIONAL
Accessory

Optical

08.8759.00

Elliptical lens



OPTIONAL
Accessory

Optical

08.8760.00

Frosted Medium lens



OPTIONAL
Accessory

Optical

08.8761.00

Frosted Flood lens