

# SmartST L Wall 82 1xLED GE

128464XX

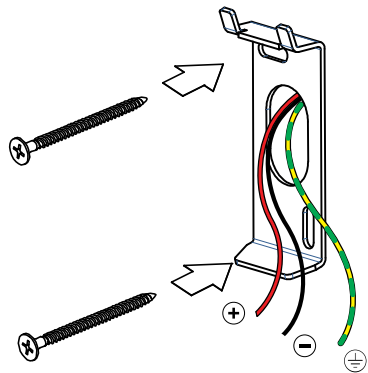

(SCREWS NOT INCLUDED)

Earth wire only to be used in combination with Smart GU10 !

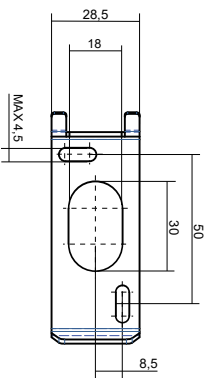
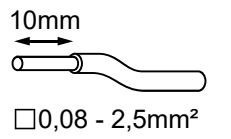

Smart 82 (IP) LED GE:  
Smart 82 adjustable LED GE:

Drive Current (mA)	Forward Voltage		Power (W)
	min (Vf)	max (Vf)	
350	16,5	19,2	6,2
500	17,1	19,8	9,2
For serial connection, respect polarity!			
⊕ RED		⊖ BLACK	

Smart 82 (IP) warmdim LED GE:  
Smart 82 adjustable warmdim LED GE:

WARM DIM			
Drive Current (mA)	Forward Voltage		Power (W)
	min (Vf)	max (Vf)	
350	15,5	18,5	6
For serial connection, respect polarity!			
⊕ RED		⊖ BLACK	

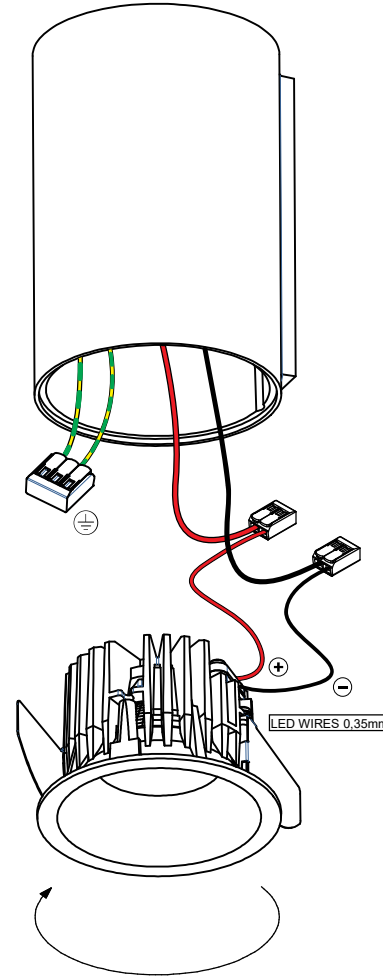
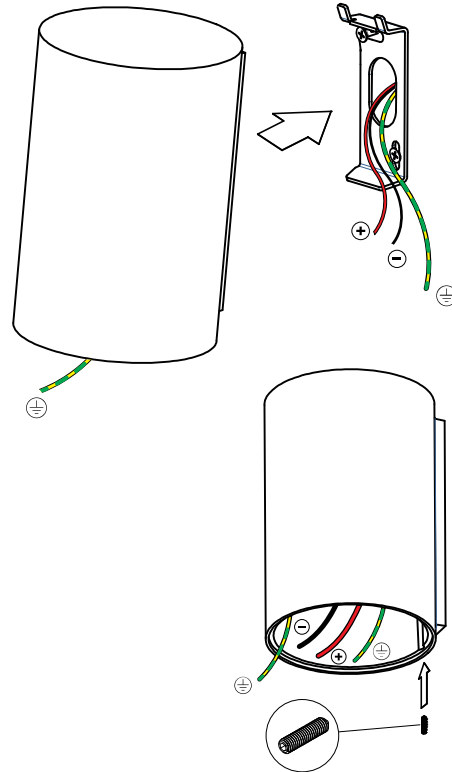

install : Twist clockwise  
uninstall : Twist counterclockwise

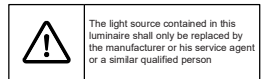
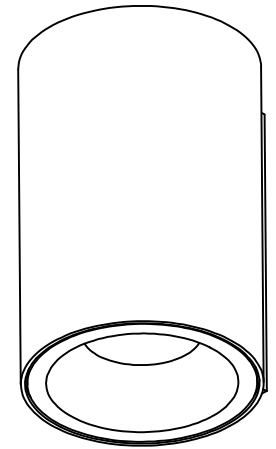

- CAN BE USED WITH :
- Smart 82 (IP\*) LED GE
  - Smart 82 adjustable LED GE
  - Smart 82 (IP\*) warmdim LED GE
  - Smart 82 adjustable warmdim LED GE
  - Smart 82 GU10 GE for tube/box

\*in combination with Smart ST Wall = IP20

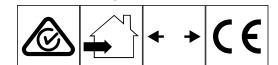

01 - 17/09/2019